

# ELI-1348 backup battery

## Rechargeable Li-ion Battery Pack

- High energy density
- SMBus battery communication technology
- Smart circuit providing remaining capacity, number of cycles and health status
- Low energy consumption during storage



### Applications

HLS, Surveillance Camera, Telecom Radio and more

### Charge Method (CCCV)

- Charging through a desktop or tactical charger or through a dedicated charging board installed in host device
- Charging Voltage: 54.6V
- Typical charging current: C/3

### Safety

- Under/over voltage
- Under/over current
- Short circuit
- Temperature

### Quality System

- ISO-9001:2008
- AS9100

### Standards

- UN38.3
- UL-1642 (for cells)

### MSDS and Disposal

- Check with manufacturer

### Electrical

Capacity (typical)	2.5Ah @ 1A & RT
Energy	117Wh
Max. voltage	54.6V
Nom. voltage	46.8V
Min. voltage	32.5V
Max. Dis. Current (cont.)	5A
Communication	SMBus Optional: Ethernet
Life Cycle	300 cycles to 80% of initial capacity @ 100% DOD 1500 cycles to 80% of initial capacity @ 80% DOD

### Mechanical

Dimensions	(L;W;H) 242mm X 72mm X 30mm
Weight	700 gr
Energy Density	167Wh/kg; 223Wh/l
Battery Housing	Tubing shrink
Color	Blue

### Environmental

Charge*	0°C to 45°C
Discharge*	0°C to 60°C
Storage:	
More than One year	-20°C to 25°C
Up to 3 months	-20°C to 45°C
Up to one month	-20°C to 60°C
Humidity	0 to 90%
Transportation	Class 9

\*Optional: Heating mechanism for operation at -40°C to 50°C

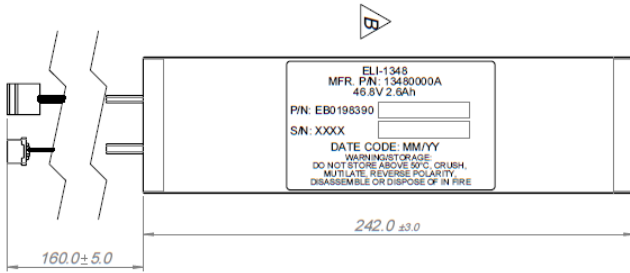
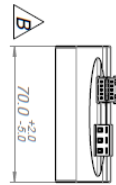

PIN No.	NOTE
1	TEMP SENSOR +V
2	N/A
3	TEMP ENSOR -V
4	N/A
5	N/A
6	CLOCK
7	N/A
8	DATA
9	GND
10	GND

MOLEX 0513531000

PIN No.	NOTE
1	BATTERY +V
2	N/A
3	BATTERY -V

MOLEX 0010013036

ISOMETRIC VIEW

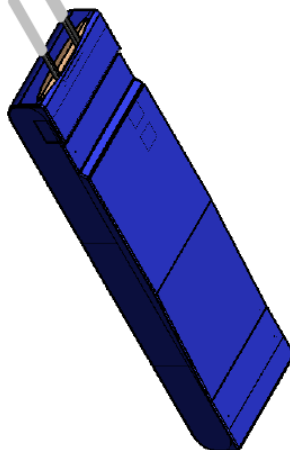

30.0 ± 0.2



REV	SH.	DESCRIPTION	DATE	ECO No.	APPR
A		NEW ISSUE	29/10/2017	-	R.A
B		LABEL UPDATE	12/03/2018	18- ECR-0198	R.A

SCALE	NAME	SIGN.	DATE	TITLE
1:2	DESIGNED: Raz Assaf	R.A	29/10/2017	epsilor TITLE SUBJECT FOR POWER
	CHKD: Alex K	Alex K	15/03/2018	
TOLERANCE	CHKD			
General: ±0.5 mm	CHKD			
Angles: 2°	CHKD			
DRAWING STATUS	APPR.	Zeev Freshman	Zeev F.	18/03/2018
<input checked="" type="checkbox"/> PRELIMINARY	DRAWING No. / PART No.: 13480000B			
<input type="checkbox"/> ENGINEERING	BREAK ALL SHARP CORNERS AND EDGES 0.2 mm			
<input type="checkbox"/> PRODUCTION	DIMENSIONS IN: mm			
WEIGHT: g				A3 SHEET 1 of 1 REV. B

File Name: C:\Epsilor\Projects\Battery\ELI-1348\Mechanical\Single\_Soldervacki\_Drawing\_13480000B\_ELI-1348\_OUTLINE.DRAWING

Last saved: 15 March 2018 10:24:29

THIS DOCUMENT IS THE SOLE PROPERTY OF EPSILOR. IT IS TO BE USED ONLY FOR THE PROJECT AND FOR THE PARTS IDENTIFIED THEREIN. ANY REUSE OR MODIFICATION OF THIS DOCUMENT WITHOUT THE WRITTEN PERMISSION OF EPSILOR IS STRICTLY PROHIBITED.